

INSTALLATION INSTRUCTIONS

Curaflex® Gasket inserts

■ Curaflex® SD

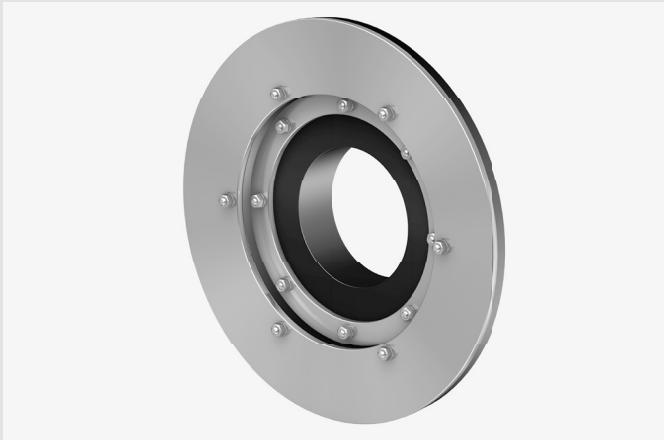

Curaflex® SD

Intended use

The Curaflex® SD gasket insert is suitable for sealing pipes/cables with smooth surfaces in concrete core boring holes or pipe sleeves in structures with existing fresh concrete composite sealing.

Please note:

- Curaflex® gasket inserts are maintenance-free. When properly installed, a re-tightening of the bolt is not necessary.
- Before installation, the diameter of the pipe and pipe sleeve/core boring diameter must be compared with the information provided on the gasket insert.
- Gasket inserts do not act as fixing points or support bearings, but rather serve exclusively to elastically seal pipes and cables.
- Axial movements and bending of the cables are not permitted.
- The sealing of thin-walled and/or foamed plastic pipes must be checked. Please contact us if necessary.

Scope of delivery

- Curaflex® SD gasket insert
- Curaflex® butyl sealing tape type 1753
- Installation instructions

Installation conditions

The seal to the pipe/cable must be performed with a core boring hole, or in an already installed pipe sleeve. The wall must be clean, level, firm, dust-free and dry in the installation area of the sealing flange. There may not be any grooves, folds or other imperfections in the area of the sealing flange on the wall surface. The gasket insert must be clean, as well as dust and grease free. If several Curaflex® SD types are arranged, the minimum distance from the sealing flange to the sealing flange is 50 mm.

Installation steps

1: Take measurements

Curaflex® SD

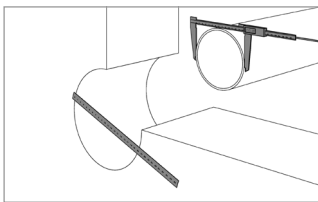

Determine the diameter of the (KB/FR) and the (ML) media line and match it with the information on the label holder.

2: Preliminary work

Curaflex® SD

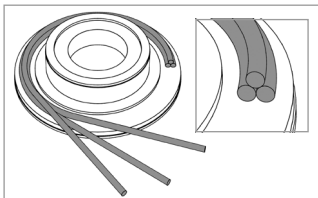

The Curaflex® butyl sealing tape (1753) is to be applied centrally on the flat gasket. Please note that two butyl sealing tapes must be placed centrally next to each other. The third butyl sealing tape is placed centrally on the previously applied butyl sealing tape.

Curaflex® SD

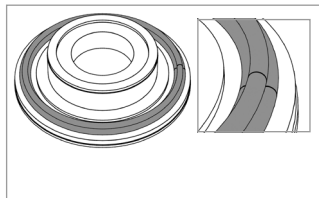

Attention: Make sure that the ends of the Curaflex® butyl sealing tapes (1753) are adjacent to each other (without gap)

3: Installing the gasket insert

Curaflex® SD

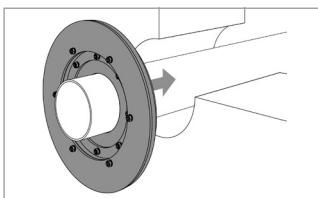

Insert the Curaflex® SD onto the media line and into the core boring/pipe sleeve until the inner steel ring touches the wall.

Curaflex® SD

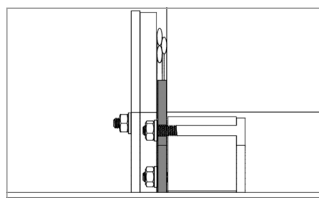

The inner steel ring lies against the wall.

4: Final Assembly

4a. Tightening of the internal nuts (Curaflex® is clamped to the KB/FR and ML)

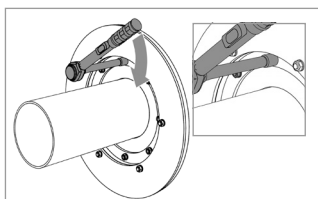

For the final assembly of the gasket insert, tighten the internal nuts until the torque shown on the side is reached (see assignment table).

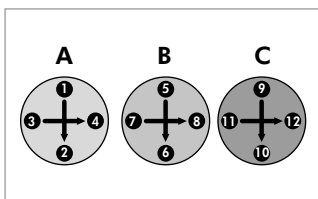

Thereby, proceed alternating: crisscross every few turns in at least 3 intervals (A>B>C).

4b. Tightening of the external nuts (Curaflex® SD is clamped to the wall)

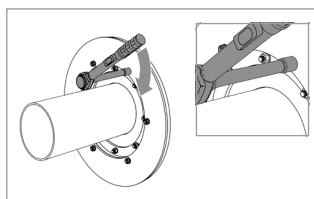

For the final assembly of the gasket insert, tighten the external nuts until the torque shown on the side is reached (see assignment table).

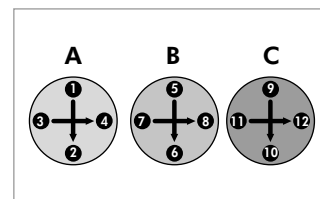

Thereby, proceed alternating: crisscross every few turns in at least 3 intervals (A>B>C).

4c. Curaflex® SD

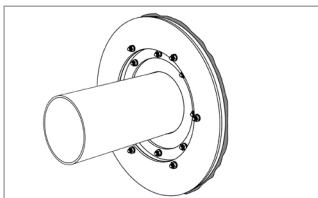

Note: Mounting is correct if butyl swells out around the outside when the screws are tightened.

5: Allocation table

DN	Pipe Ø [mm]	Bolt [mm]	Torque Internal nut [Nm]	Bolt [mm]	Torque External nut [Nm]
80	5 – 40	M6	5	M6	5
100	5 – 63	M6	5	M6	5
125	58 - 78	M6	5	M6	5
150	63 – 112	M6	5	M6	5
200	108 – 160	M6	5	M6	5
250	154 – 201	M6	5	M6	5
300	198 – 230	M8	12	M8	12
350	234 – 288	M8	12	M8	12
400	289 – 339	M8 / M12	12 / 30	M8	12
450	340 – 380	M8 / M12	12 / 30	M8	12
500	381 – 430	M8 / M12	12 / 30	M8	12
600	431 - 530	M12	30	M8	12



DOYMA products are continuously being further developed. Technical changes will be performed without prior notice.
25 year warranty on all DOYMA products. **More information at www.doyma.de**

DOYMA GmbH & Co

SEALING SYSTEMS
FIRE PROTECTION SYSTEMS

Industriestr. 43-57
28876 Oyten

Phone: 0 42 07/91 66-300
Fax: 0 42 07/91 66-199

www.doyma.de
info@doyma.de

245590-01/10.19

25
years
guarantee

