

# INSTALLATION NOTES

## Curaflex® gasket inserts

- Curaflex® SD



Curaflex® SD

### Intended purpose

The Curaflex® SD gasket insert is suitable for sealing pipes/cables with a smooth surface in concrete core bores or pipe sleeves in buildings with fresh concrete bonded waterproofing membrane.

### Please note

- Curaflex® gasket inserts are maintenance-free. Once correctly installed, it is not necessary to re-tighten the bolts.
- Before installation, compare the diameter of the pipe and pipe sleeve/core bore with the specifications on the gasket insert.
- Gasket inserts are not secure points or support bearings; they are only used for elastic sealing of pipes.
- Axial movements and bending of the lines are not permitted.
- The sealing of thin-walled and/or foamed plastic pipes must be checked. Contact us if necessary.
- Pipe sleeves must have sufficient rigidity to absorb the compressive forces from the seal insert and a smooth circular inner surface. If the pipe sleeve is damaged, its usability must be checked in advance.
- The sealing to the service pipe/cable/cable protection pipe must be carried out in a WU concrete core bore or in an already installed pipe sleeve.

### Scope of delivery

- Curaflex® SD gasket insert
- Curaflex® butyl sealing tape type 1753
- Installation notes

### Installation conditions

The pipe/cable must be sealed in a concrete core bore or in an already installed pipe sleeve. The wall in the installation area of the sealing flange must be clean, flat, firm, dust-free and dry. There must be no grooves, creases or other defects on the wall surface in the area of the sealing flange. The gasket insert must be clean and free of dust and grease. When several Curaflex® SD types are arranged, the minimum distance from sealing flange to sealing flange is 50 mm.

## Installation steps

### 1: Take measurements

#### Curaflex® SD

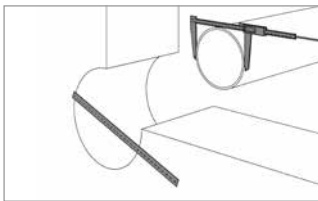

Determine the diameter of the core bore/ pipe sleeve (KB/FR) and the media line (ML) and compare it with the information on the sticker holder.

### 2: Preparatory work

#### Curaflex® SD

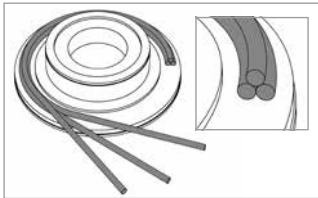

Apply the Curaflex® butyl sealing tape (1753) to the centre of the flat seal. Make sure that two butyl sealing tapes are positioned side by side in the middle. The third butyl sealing tape is placed centrally on the previously applied butyl sealing tape.

#### Curaflex® SD

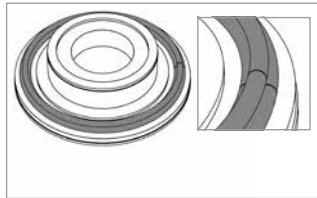

Attention: Make sure that the ends of the Curaflex® butyl sealing tapes (1753) are aligned (without gaps)

#### Curaflex® SD

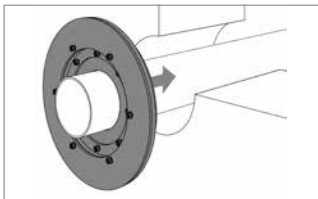

Push the Curaflex® SD onto the media line and into the core bore/pipe sleeve until the internal steel ring rests against the wall.

#### Curaflex® SD

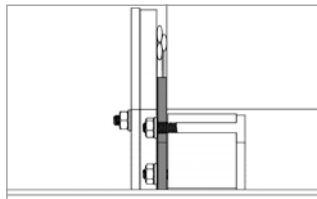

The internal steel ring rests against the wall.

## 4: Complete the installation

### 4a. Tightening the internal nuts (Curaflex® SD is tightened to core bore/pipe sleeve (KB/FR) and to media line (ML))

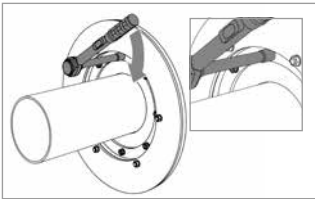

For final installation of the gasket insert, tighten the internal nuts until the adjacent torque is reached (see assignment table).

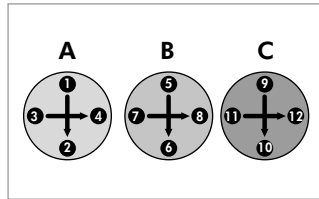

Alternate cross-wise: several turns each in at least three intervals (A>B>C).

### 4b. Tightening the external nuts (Curaflex® SD sealing flange pressed onto the wall)

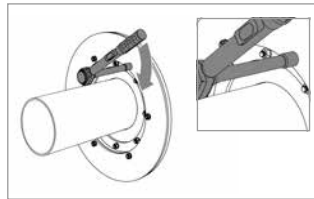

For final installation of the gasket insert, tighten the external nuts until the adjacent torque is reached (see assignment table).

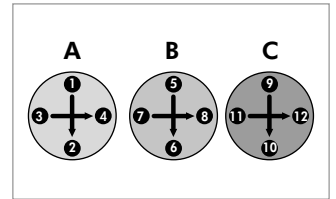

Alternate cross-wise: several turns each in at least three intervals (A>B>C).

### 4c. Curaflex® SD

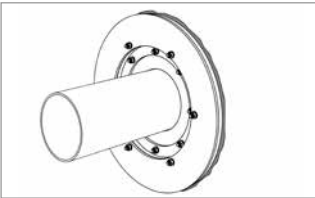

Note: installation is correct if butyl oozes out around the outside when tightening the screws.

## 5: Assignment table

| DN  | Pipe Ø [mm] | Bolt [mm] | Torque Internal nut [Nm] | Bolt [mm] | Torque External nut [Nm] |
|-----|-------------|-----------|--------------------------|-----------|--------------------------|
| 80  | 5–40        | M6        | 5                        | M6        | 5                        |
| 100 | 5–63        | M6        | 5                        | M6        | 5                        |
| 125 | 58–78       | M6        | 5                        | M6        | 5                        |
| 150 | 63–112      | M6        | 5                        | M6        | 5                        |
| 200 | 108–160     | M6        | 5                        | M6        | 5                        |
| 250 | 154–201     | M6        | 5                        | M6        | 5                        |
| 300 | 198–230     | M8        | 12                       | M8        | 12                       |
| 350 | 234–288     | M8        | 12                       | M8        | 12                       |
| 400 | 289–339     | M8/M12    | 12 / 30                  | M8        | 12                       |
| 450 | 340–380     | M8/M12    | 12 / 30                  | M8        | 12                       |
| 500 | 381–430     | M8/M12    | 12 / 30                  | M8        | 12                       |
| 600 | 431–530     | M12       | 30                       | M8        | 12                       |

DOYMA products are continuously being further developed. Technical changes will be performed without prior notice.  
25 year warranty on all DOYMA products. **More information at [www.doyma.de](http://www.doyma.de)**

**DOYMA GmbH & Co**

SEALING SYSTEMS

FIRE PROTECTION SYSTEMS

Industriestr. 43-57  
28876 Oyten

Phone: 0 42 07/91 66-300  
Fax: 0 42 07/91 66-199

[www.doyma.de](http://www.doyma.de)  
[info@doyma.de](mailto:info@doyma.de)

25  
years  
guarantee

