

# Mounting flange-seal packing

BKD 150-AF, KD 150-AF, BKD 90-AF



Assembly instructions

## Preparations and instructions for assembling the mounting flange

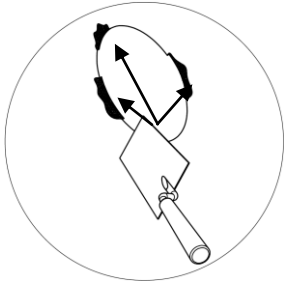

- The mounting flange area must be level and clean.
- It is necessary to remedy irregularities and break-outs.
- If necessary, rework the seal on the mounting surface.

## Dimensions of the holes

| System         | Core drill hole Ø | Axial spacing | Wall plug hole spacing |
|----------------|-------------------|---------------|------------------------|
| BKD 150-AF 235 | max. 150 mm       | min. 245 mm   | 185 mm                 |
| KD 150-AF 200  | max. 150 mm       | min. 210 mm   | 165 mm                 |
| BKD 90-AF 150  | max. 90 mm        | min. 160 mm   | 120 mm                 |

## Mounting flange assembly

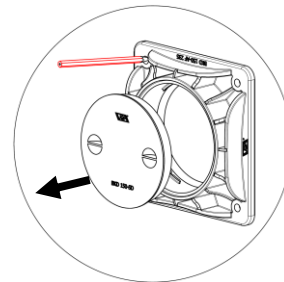

- Remove protective cover from the mounting flange.
- Align mounting flange with core drill hole/wall sleeve and mark drilling position for the wall plug holes.

**Attention: Wall plugs are intended for concrete. With all other materials, the customer must check which fastening elements can be used.**

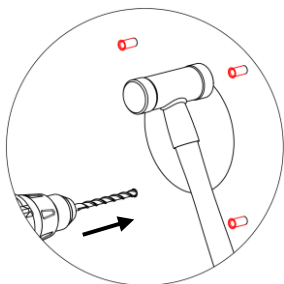

- Drill a hole at least 80 mm deep with a masonry drill bit Ø 10 mm. Drill perforated bricks and hollow blocks without a hammer mechanism.
- Clean drilled holes.
- Knock wall plug flush into drilled hole.

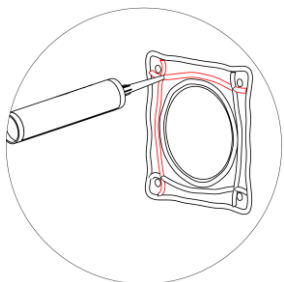

- For additional sealing and adhesion, apply UGA-Sikaflex-11 FC (**not included in the scope of supply**) in a grid pattern around the holes, in the area of the mounting surface.

# Mounting flange-seal packing

BKD 150-AF, KD 150-AF, BKD 90-AF



Assembly instructions

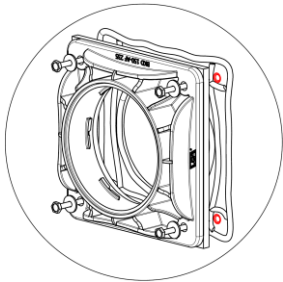

- Align rubber seal and mounting flange-seal packing and insert screws with washers in wall plugs.

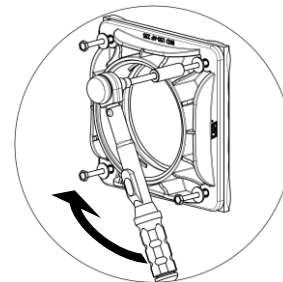

- Screw in the screws (width across flats 13 mm) up to the stop. The wall plug is correctly anchored if, once the screw has been screwed in fully, the wall plug does not rotate and it is not possible to turn the screw any further.
- The wall plug must only be mounted once.

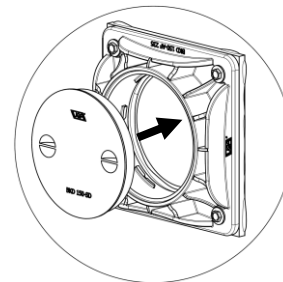

- If immediate mounting of a system cover is not intended, the protective cover/PE cover must be pressed back into the mounting flange as protection.

**It is necessary to ensure that the pipes/cables to be connected exhibit no damage in the area of the seal. It is necessary to ensure that no tensile/pressure forces and mechanical loads act on the pipes/cables to be connected, and on the penetration.**

### Important note:

**We accept no warranty claims in case of deviations from the information in the assembly instructions and/or with incorrect use of our products.**

**This also applies to combinations with external products that have not been approved by us.**

### General:

Observe the nationally valid installation and filling specifications of the pipe manufacturer!

Compact the substrate and cable foundation well before cable/pipe installation, so that the cables/pipes cannot sink. Incorrect cable or protection pipe installation and unprofessional filling of the cable trench leads to settling, which can in turn lead to damage.

Only open cable penetrations directly before fitting with cables, in order to avoid unintentional damage during structural work.

**You find assembly instructions in other languages on the side [www.uga.eu](http://www.uga.eu) or on inquiry!**