

# Accessory set for thick coatings

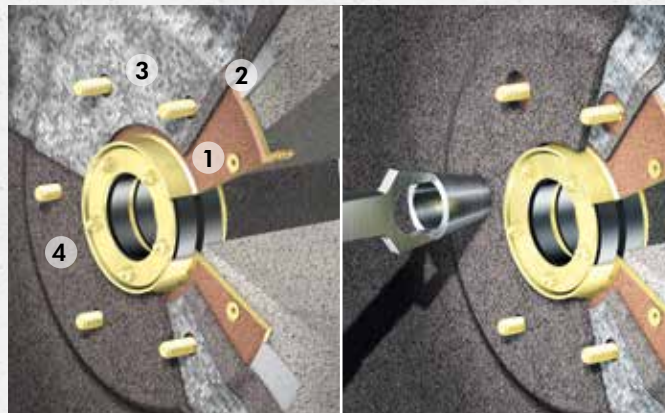
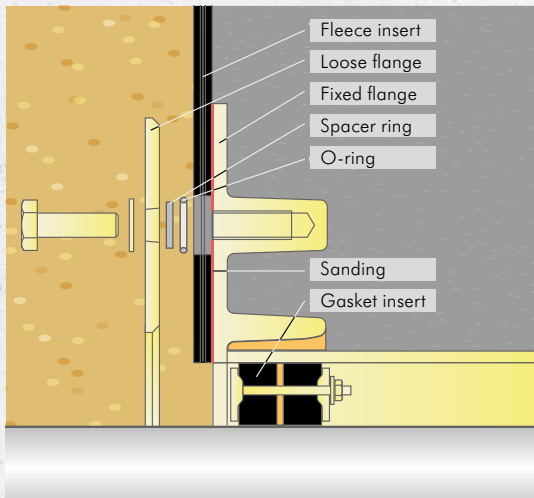

Layers from bottom to top: sanding (1), thick coating (2), fleece insert (3), thick coating (4)

Punching out holes using the punch tool.

25 Jahre Garantie

## ACCESSORY SET FOR THICK COATING:

Consists of spacer rings, O-rings and fleece insert. These parts are matched to the dimensions and the holes of the selected fixed/loose flange design.

## APPLICATION DESCRIPTION

The contact surfaces/inner surfaces of the fixed and loose flanges of the Curaflex® 5000, C/2/SD/5, F/2/SD/5 and the Curaflex® 6000, 7000, 8000, C/2/SD/6 and F/2/SD/6 are sanded. The carrier material used for the solder sand is WEROPOX-EP primer no. 6142 with hardener 6141-H.

The area around the holes or around the bolts, where the O-rings and the washers are positioned, must not be sanded. Diameter of these surfaces: 40 mm for non-pressing water, 55 mm for pressing water.

The Curaflex® 4005 and 4006 pipe sleeves do not require sanding. The thick coating of bitumen is to be applied in several layers according to the manufacturer's instructions. After the first layer has been applied, the fleece insert, which is circumferentially 100 mm larger than the fixed flange, is pressed into the

layer while it is still wet. The fleece insert is then coated wet so that the minimum dry-layer thickness for the present load case is achieved. Once the drying time specified by the manufacturer has elapsed, the bitumen filler compound, depending on the design of the fixed and loose flange, is then punched out around the tapped holes or bolts, e.g. using a punch tool.

Between the flanges there are 4 mm thick spacer rings in the case of Curaflex® products against pressing water, and 3 mm thick spacer rings in the case of Curaflex® products against non-pressing water, arranged around each bolt. This prevents the entire bitumen filler compound from being squeezed out when the loose flange is tightened, thus achieving a defined layer thickness of the bitumen filler compound between the fixed flange and the loose flange.

Rubber O-rings are also arranged around the bolts and around the spacer rings in order to prevent possible pressure losses around the bolts.

Product	Article number		
Punch for thick coating*	For pressing water	1777/6, for approx. 2 applications	1 99 6 777 000 0 0
	For non-pressing water	1777/5, for approx. 2 applications	1 99 5 777 000 0 0

\*Excluded from the 25-year DOYMA warranty.



**ATTENTION!** WHEN INSTALLING STEEL PIPE SLEEVES IN OR ON BUILDING WALLS WITH A THICK COATING, THE CONTACT SURFACES MUST BE SANDED AT THE FACTORY. IN SUCH CASES, PLEASE BE SURE TO SPECIFY THE FOLLOWING WHEN PLACING AN ORDER: 'FOR THICK COATING'.

