

INSTALLATION NOTES

DOYMAfix® HP/O

- DOYMAfix® HP/O
- DOYMAfix® Connect HP/O

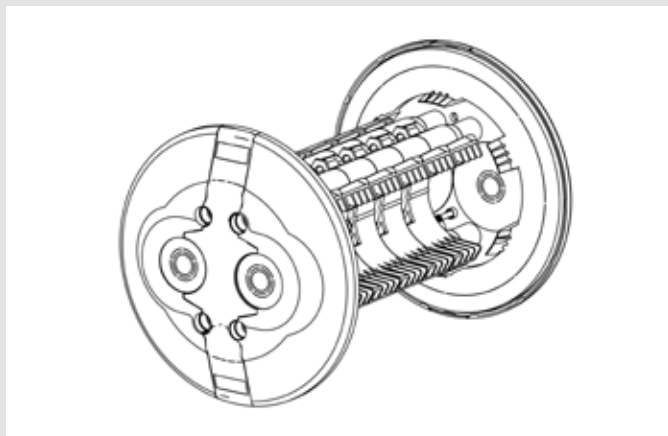

DOYMAfix® HP/O

Dear Customer,

Thank you for choosing a quality product from our range.

Please read this message and the included installation instructions in full before installing or processing our products and keep both in a safe place after installation.

Safety instructions:

- Our products may only be installed by persons with the necessary specialist knowledge.
- For your own protection and the protection of third parties, the work area and any necessary pipe trenches must be properly constructed and secured in accordance with the applicable regulations.
- When installing our sealing and fire protection systems, the recognised rules of technology, the relevant regulations of the employers' liability insurance associations, the VDE regulations and the applicable safety and accident regulations must be observed. Parts of the body may be crushed or other serious injuries may occur when tensioning or fixing the products in place.
- The safety data sheets must be observed.
- Check that the delivered product is complete (the scope of delivery is listed separately in the installation instructions) and check all individual parts for any damage. Only undamaged parts may be installed.
- Check that the product is suitable for its intended use using the installation instructions. If there are any particular demands,

please clarify the use of the product with us in advance. Request our checklists for this purpose or download them from www.doyma.com.

Any liability on our part is excluded for misuse!

- Finally, please observe the instructions for the tools and equipment required for installation.

Industrial property rights:

- Our industrial property rights and those of third parties must be observed.

Disposal:

- Please observe the applicable regulations when disposing of components, accessories and packaging.

Terms and conditions of sale:

- The current version of our terms and conditions of sale and delivery shall prevail.

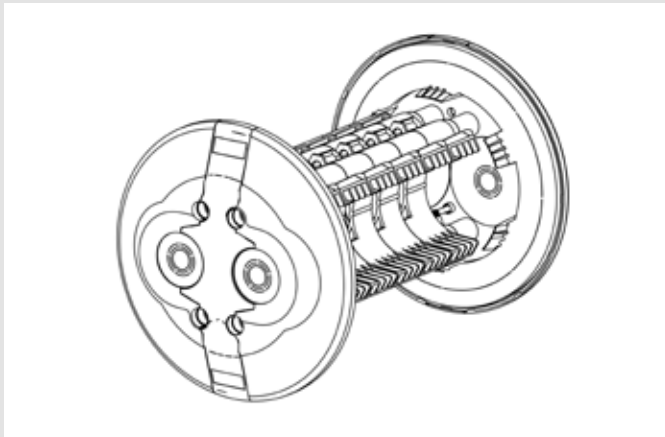

DOYMAfix® HP/O

Intended use

Sealing of connecting pipes for heat pumps in above-ground wall bushing.

Universally usable in all common wall structures.

Please note:

- Protect the wall bushing from damage, moisture and contamination.
- Inspect all individual parts for any damage. Only undamaged parts may be installed.
- Please note that no warranty claims whatsoever will be accepted for consequential damage caused by deviating from the specifications and instructions in the installation notes, using our products not in the intended way or combining our products with third-party products.
- An expansion foam is used during assembly.
- The instructions on the packaging and the safety data sheet must be observed!

Installation conditions:

Existing breakouts, cracks and/or gaps must be levelled out in advance. The media line (cable or pipe) to be sealed must be cleaned in advance and must not have any axial depressions or elevations in or around the sealing area.

To install the wall bushing correctly, you will need the following tools and aids in addition to the usual standard tools:

Required tools and equipment

- Drilling device with drill bit or drilling tool for drilling Ø 200 mm
- Ratchet with socket wrench attachment Torx T40
- Suitable protective equipment

Scope of delivery

The scope of delivery of the DOYMAfix® HP/O or Connect HP/O includes:

- Inner seal (incl. 2 intermediate segments)
- Outer seal
- Intermediate segments (8 pieces)
- Expansion foam
- Mounting screws (2 pieces)
- Cover caps, split (2 pieces)
- Stainless-steel connecting hoses (only for the Connect HP/O) (2 pieces)
- Installation notes

Accessories (optional)

- Compriband
- Intermediate segment (set of 4)
- Expansion foam
- Sealing set for refrigerant lines for split systems
- Large cover cap (3-part)

Einbauschritte

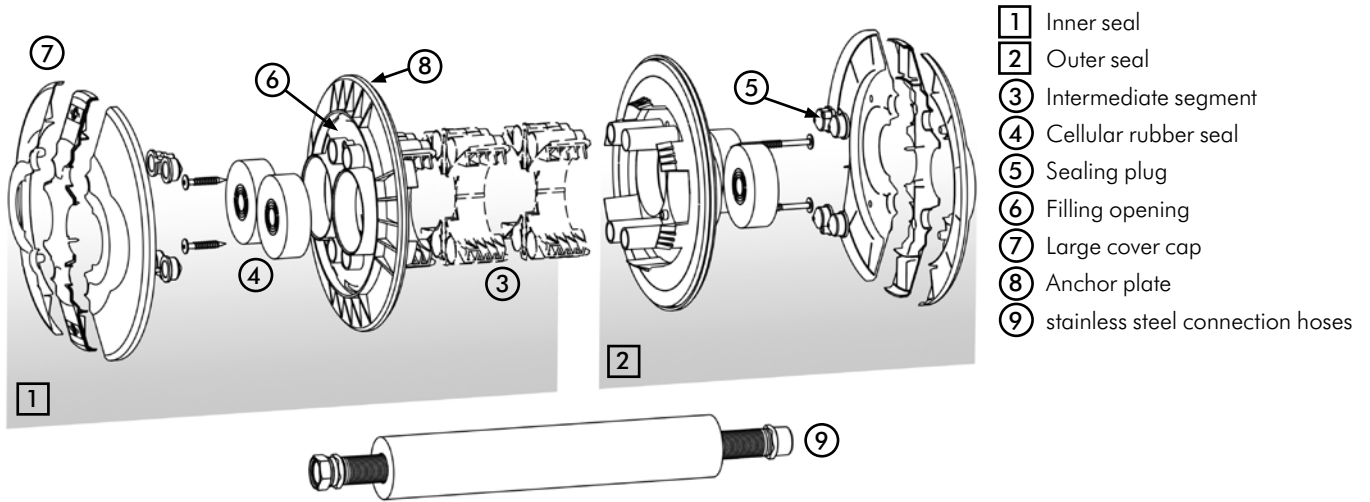

Establishing the penetration

The wall duct can be installed in a core drill hole or a casing pipe installed on site. The drilling device can be guided by hand or using a drill stand. Only solid material can be drilled. Breakouts can occur in porous or brittle masonry material. No reworking is required for smaller break-outs. For walls whose inner wall surface is not the airtight layer, a lining pipe must be used. The airtightness level must be connected to the lining pipe in accordance with the system. In the case of large break-outs, the opening must be repaired in accordance with the respective wall structure. Substrates must be clean, solid and free of dust and grease. Wall thickness a: 120 mm - 545 mm (additional accessories are required for greater wall thicknesses)

Core drill hole/lining pipe Diameter b: 199 mm - 204 mm

Note: If the wall opening is produced using an alternative method (e.g. sawing, chiselling), a maximum internal diameter of 220 mm must not be exceeded.

Assembling [1] and installing the inner seal

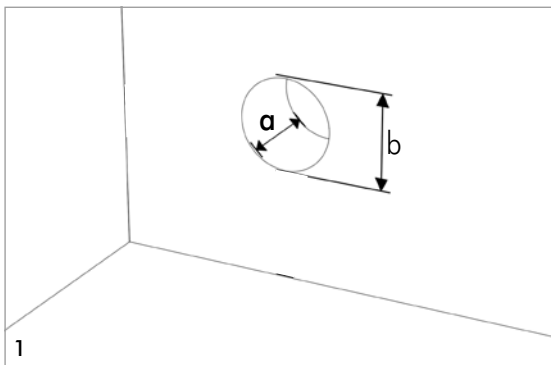

1. Measure the thickness of your wall
2. Depending on the wall thickness, additional intermediate segments must be installed.

Wall thickness (a)	Total required intermediate segments	Additional intermediate segments to be installed
120–145 mm	2	None (intermediate segments are already preassembled)
146–195 mm	3	+1
196–245 mm	4	+2
246–295 mm	5	+3
296–345 mm	6	+4
346–395 mm	7	+5
396–445 mm	8	+6
446–495 mm	9	+7
496–545 mm	10	+8
≥546 mm	Additional accessories required (intermediate segment, set of 4)	

Installation steps

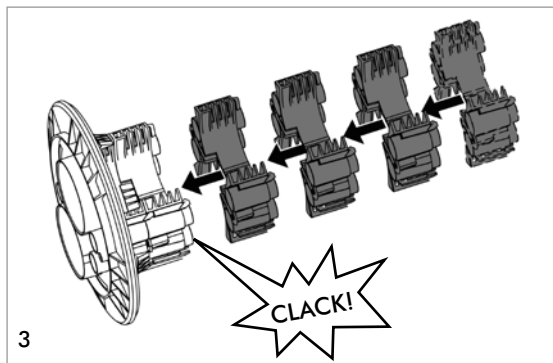

3. Installation of intermediate segments.
The intermediate segments must noticeably engage with each other.

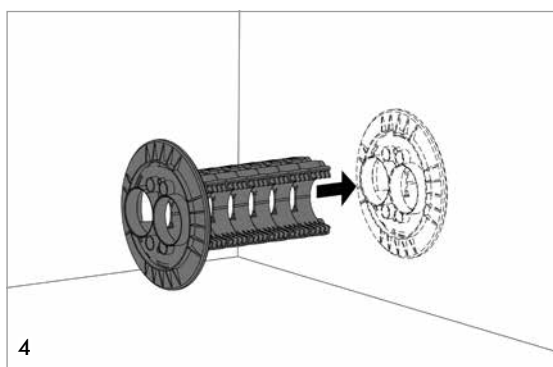

4. Insertion of inner seal until it lies against the plastered wall surface.

Attention: If the inner wall surface does not represent the airtightness level, a lining pipe provided by the customer must be used (see also notes on creating the penetration on page 3).

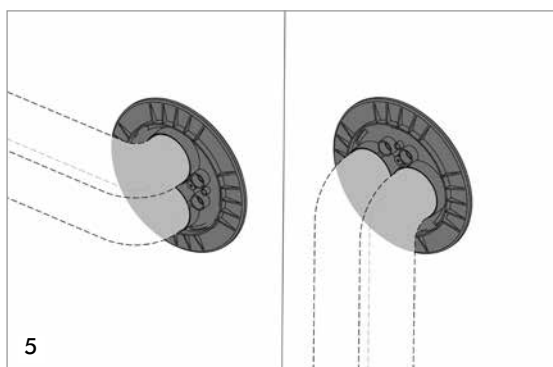

5. Alignment of inner seal according to the planned pipe routing.

Outer seal [2]

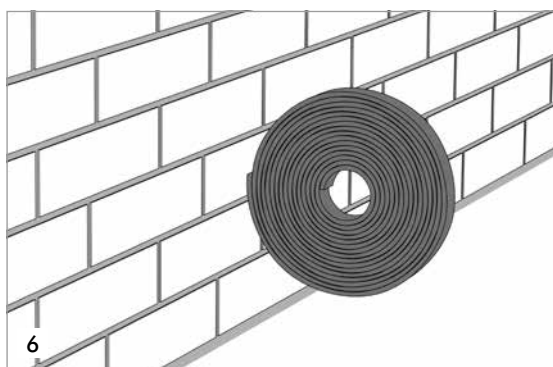

Optional installation step

6. Application of compriband in the event of uneven walls
When installing on uneven wall surfaces >3 mm (such as brick or similar), an additional compriband is required (optional accessories).
Otherwise, go to step 7.

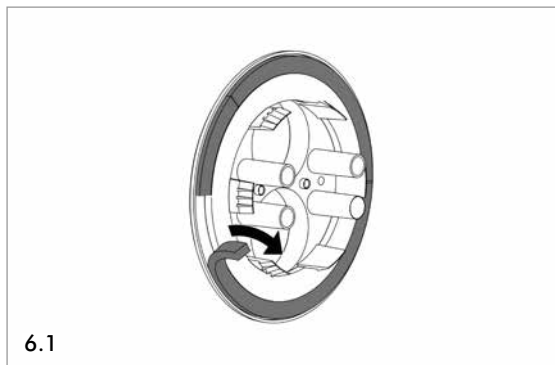

6.1 Removal of outer sealing ring.

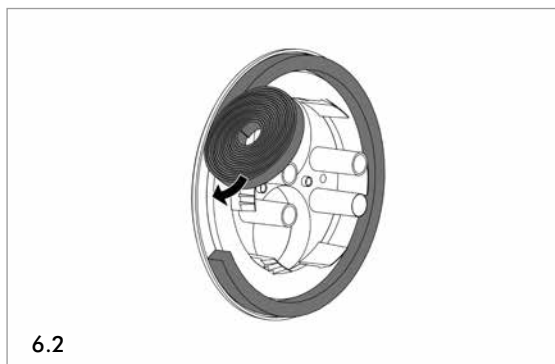

6.2. Affixing of compriband.

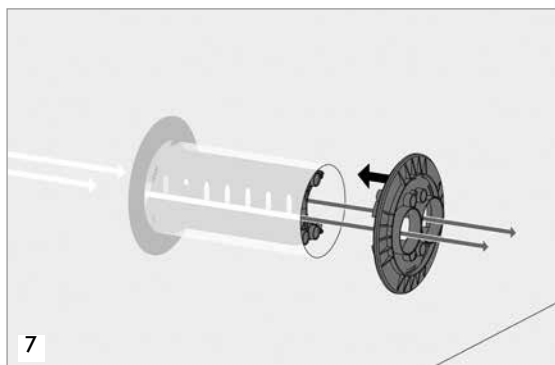

7. Insertion of outer seal.

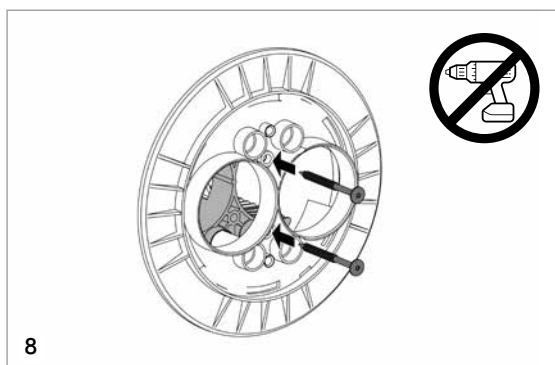

8. Screwing of outer seal [2] to inner seal [1].



To screw the external seal in place, it is advisable to hold the intermediate segments in place through the component openings. This prevents the internal sealing components from slipping. Screwing is carried out using a ratchet (Torx T40). Screwing is carried out using a ratchet (Torx T40).



Depending on the temperature, the compriband takes up to an hour to fully expand.

Sealing the pipes

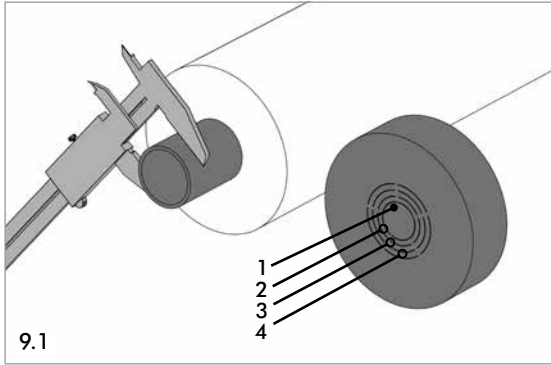

- 9.1 Measuring of pipe (not applicable for the Connect HP/O, s. Pkt 9.2).
Adjustment of the cellular rubber seals (4) (not applicable on the Connect HP/O).
- 1) Remove blind plug 1: \varnothing 22 mm
 - 2) Remove blind plug 1 and onion ring insert 2: \varnothing 28 mm
 - 3) Remove blind plug 1 and onion ring inserts 2 and 3: \varnothing 35 mm
 - 4) Remove blind plug 1 and onion ring inserts 2,3 and 4: \varnothing 42 mm

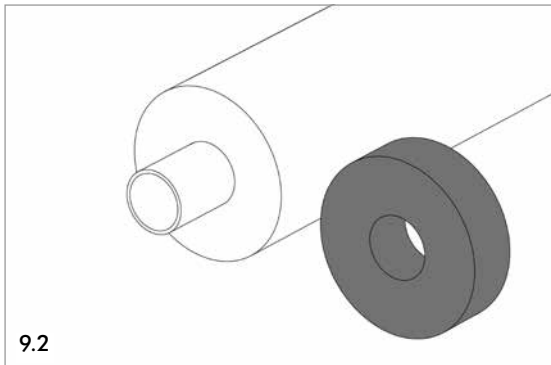

- 9.2 Cellular rubber seals for Connect HP/O.
Cellular rubber seals (4) are designed for the respective version (DN25 or DN32). No customisation required. The length of the corrugated stainless steel hoses (10) is 800 mm (maximum extension up to 1,600 mm).

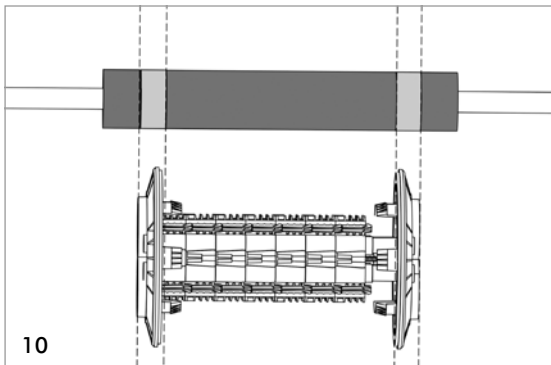

10. Structural pipe insulation should be omitted in the area of the cellular rubber seals (4).

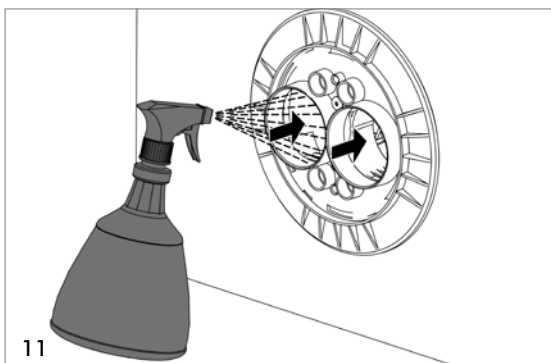

11. To increase the reactivity of the expansion foam, please wet the interior surfaces with water through the component openings before installing the pipes.

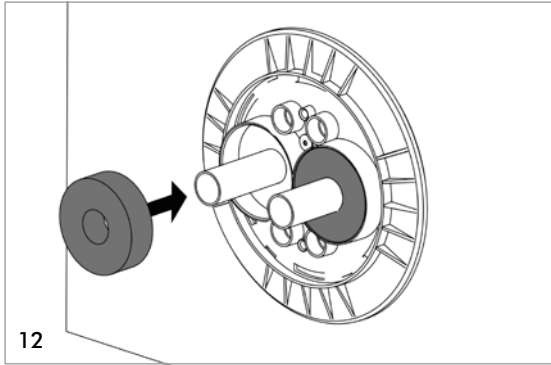

12. Setting the cellular rubber seals (4).
Lubricant can be used for easier installation.
(Flush with anchor plate (8)).

Insertion of expansion foam (inner seal)

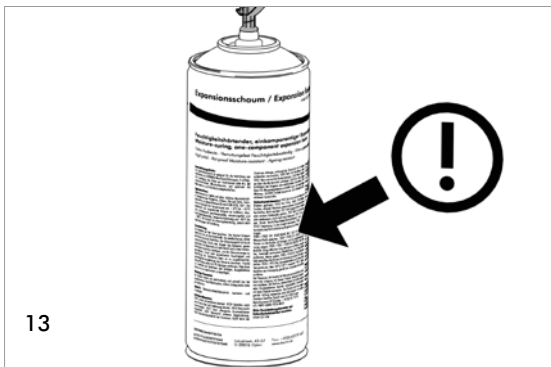

13. The instructions on the can must be observed.

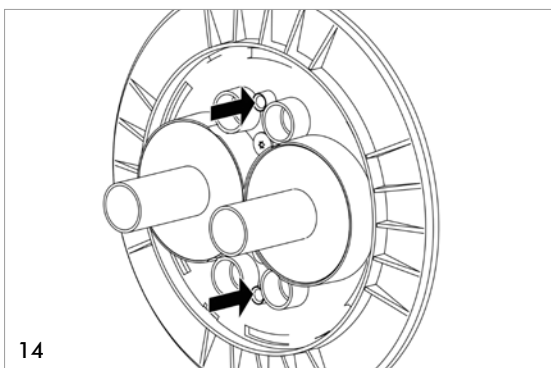

14. Insertion is carried out evenly via both filling openings (6).

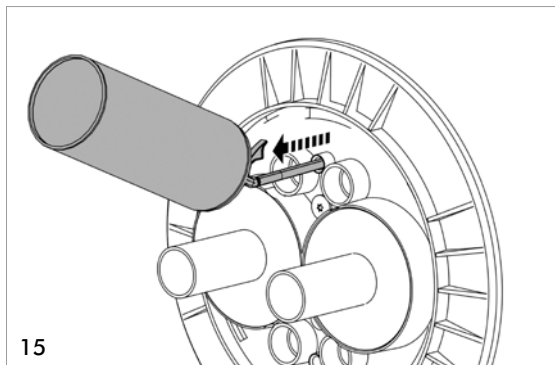

15. Insertion of foam.
Fully insert the filling hose.
While inserting, slowly pull the filling hose out of the opening.



The fresh foam still expands one-and-a-half to two-fold. Therefore do not overfill the cavities for very thin wall thicknesses.



For wall thicknesses >500 mm, an additional can of expansion foam may be necessary (optional accessory).

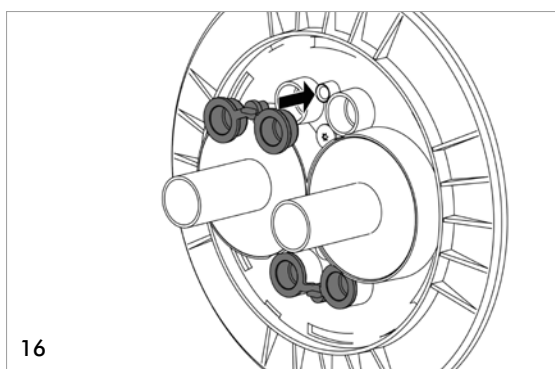

16. Insert the sealing plug (5) including cable seals on the inside and outside of the building.

Placement of electrical wiring

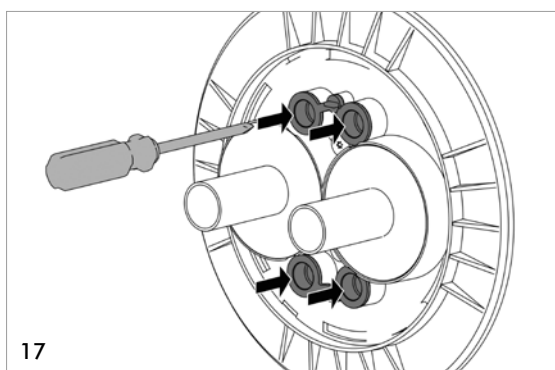

17. Cutting through cable bushing for the power and control lines.

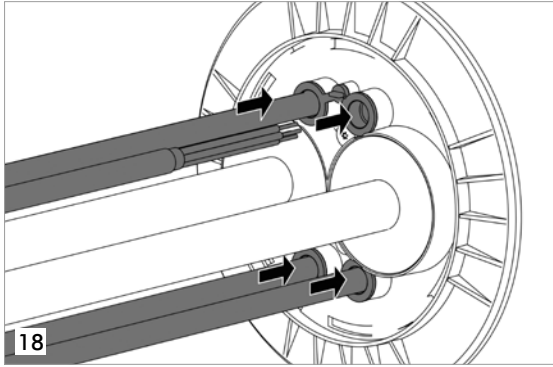

18. Routing of electrical wiring.

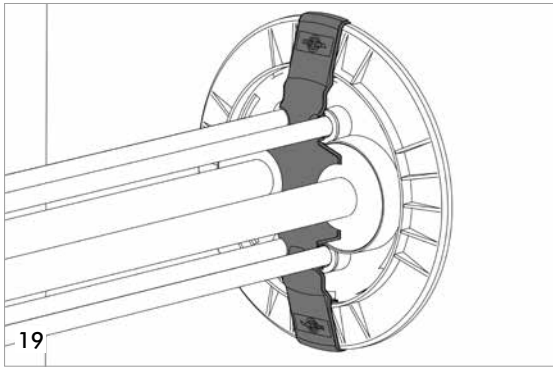

19. Place the middle segments on the anchor plate.

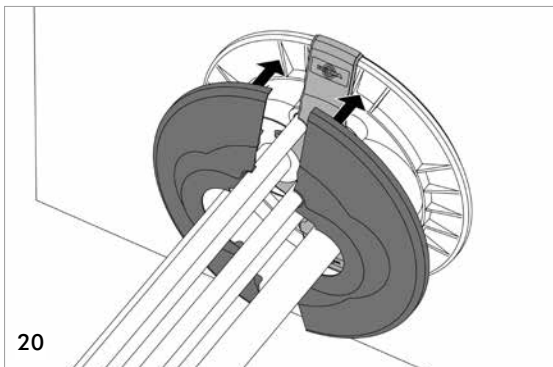

20. Then install the side panels.

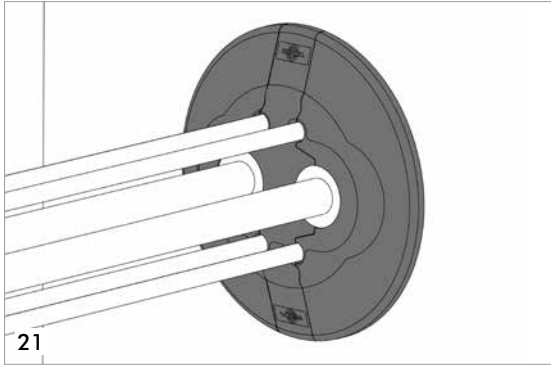

21. Cover cap fully assembled.

DOYMA products are continuously being further developed. Technical changes will be performed without prior notice.
25 year warranty on all DOYMA products. **More information at www.doyma.de**

DOYMA GmbH & Co

SEALING SYSTEMS
FIRE PROTECTION SYSTEMS

Industriestr. 43-57
28876 Oyten

Phone: 0 42 07/91 66-300
Fax: 0 42 07/91 66-199

www.doyma.de
info@doyma.de