

INSTALLATION INSTRUCTIONS

HKD KE-Pipe sleeve with bonding flange

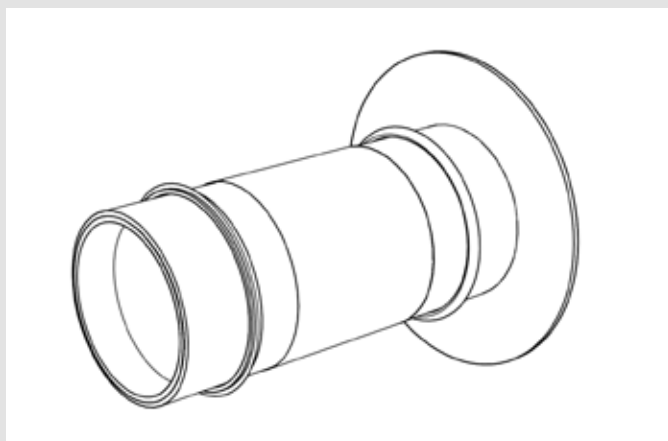

HKD KE-Pipe sleeve with bonding flange

Intended use

Cement pipe sleeve with bonding flange for installation walls, ceilings and floor slabs.

Suitable for sealings made of:

- plastic modified bitumen coatings (PMBC/KMB) with pressing water up to a 3 m water column (W2.1-E according to DIN 18533)
- crack-bridging mineral sealing slurries (MDS) with soil moisture and non-pressing water (W1-E according to DIN 18533)
- liquid plastics (FLK) with non-pressing water on earth covered ceilings (W3-E according to DIN 18533)

The pipe sleeve is used to accommodate a gasket insert (not included in the scope of delivery).

Please note:

Machining instructions for installation can be found on the following pages.

For sealing the annular space between the pipe/cable and pipe sleeve you will need a sealing element. We recommend installing a Curaflex® or HKD DOMO gasket insert.

Visual inspection of pipe sleeves for defects or damage upon delivery and before installation.

The pipe sleeves must be properly stored and protected against damage.

The storage temperature must be between 5 and 30°C; avoid direct sunlight in all cases.

If the pipe has already been laid, then the pipe sleeve must be positioned and fixed centrally around the pipe before concreting.

Scope of delivery

- Pipe sleeve
- Installation instructions

Accessories (optional)

Gasket insert: Curaflex®, Curaflex® Nova or HKD DOMO

Further accessories on request.

Installation conditions

The bonding flange must be clean and free of dust and grease. As a rule, the specifications for flange constructions according to DIN 18195/DIN 18533 must be as follows:

The distance from flange outer edge to flange outer edge or to other components, for example, building edges and grooves or wall connections, must be at least 150 mm in the case of non-pressing water, and at least 300 mm in the case of pressing water. In the case of expansion joints, distances of at least 300 mm must be maintained for non-pressing water and at least 500 mm for pressurised water, unless a larger distance is required for processing reasons.

Installation conditions

The bonding flange must be clean and free of dust and grease. As a rule, the specifications for flange constructions according to DIN 18195/DIN 18533 must be as follows:

The distance from flange outer edge to flange outer edge or to other components, for example, building edges and grooves or wall connections, must be at least 150 mm in the case of non-pressing water, and at least 300 mm in the case of pressing water. In the case of expansion joints, distances of at least 300 mm must be maintained for non-pressing water and at least 500 mm for pressurised water, unless a larger distance is required for processing reasons.

Position the movable SBR lip seals on the smooth surface of the pipe sleeve.

If the pipe sleeve needs to be cut to size on site, observe the following instructions.

Cut the pipe sleeve on the non-water side. Do not cut off more than 30 mm of the pipe sleeve.

Tools:

- Handheld hammer when using formwork holders
- Compactor (e.g. internal vibrator)
- Manual saw (for cutting only)

Equipment

- Tie wire and pliers for securing to reinforcement steel
- Pipe clamps when inserting in steel formwork

Processing notes

HKD KE-Pipe sleeve

1 Breakthrough min. 50 mm larger

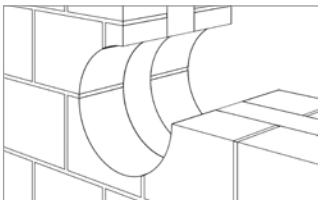

The breakthrough should be at least 50 mm larger than the surrounding area. Outer diameter of the pipe sleeve to be inserted.

2 Pipe sleeve cemented in

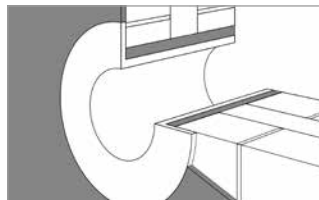

Pipe sleeve cemented into wall opening. Bonding flange flush with wall.

3 Pipe sleeve with sealing plug

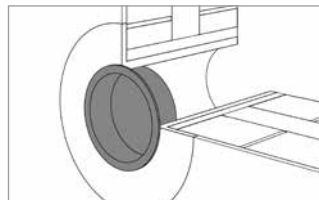

Protect the pipe sleeve during the shell construction phase with sealing plug.

HKD KE-Pipe sleeve for thick coating

1 Application of the thick coating

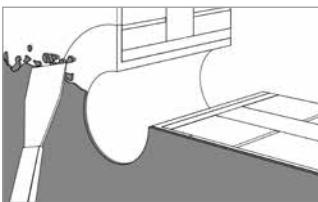

Apply the first layer of the PMBC/KMB (for more information see DIN 18195/DIN 18533) on the wall and the bonding flange. Observe the processing guidelines for the production of PMBC/KMB!

2 Fleece insert

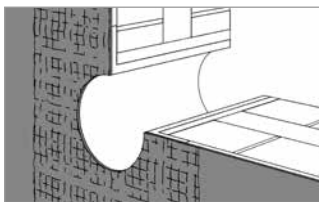

Slightly press the fleece insert into the thick coating.

3 Application of the second layer

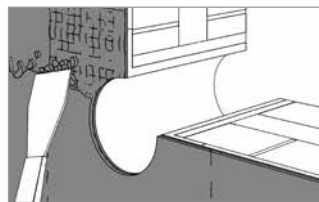

Apply the second layer of the PMBC/KMB. Observe the processing guidelines for the production of PMBC/KMB!

HKD KE-Pipe sleeve for sealing slurries (MDS)

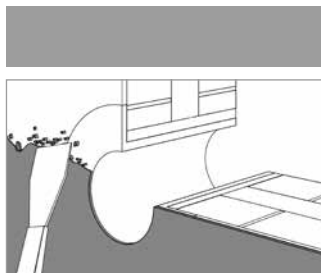

Apply the first layer of the MDS (for more information see DIN 18195/DIN 18533) to the wall and the bonding flange. Observe the processing guidelines for creating the MDS!

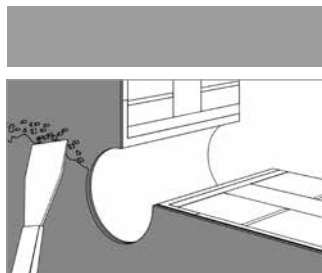

Apply the second layer of the MDS (for more information see DIN 18195/DIN 18533) to the wall and the bonding flange. Observe the processing guidelines for creating the MDS!

HKD KE-Pipe sleeve for liquid plastics (FLK)

1 Application of the first layer

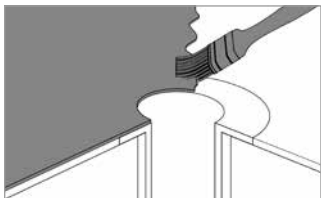

Apply the first layer of the FLK (for further information see DIN 18195/DIN 18533) on the wall and the bonding flange. Observe the processing guidelines for creating the FLK!

2 Building-side insert

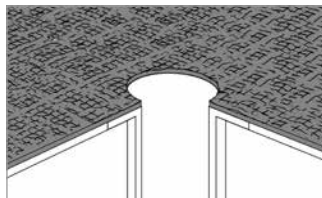

Integrate building-side inlays of the FLK system according to the specifications of the FLK manufacturer.
Note: Do not use the supplied fleece (fibreglass matting).

3 Application of the second layer

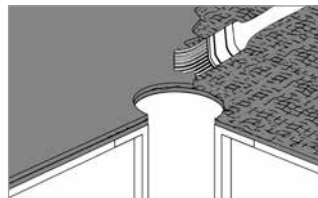

Apply the second layer of the FLK (for further information see DIN 18195/DIN 18533) on the wall and the bonding flange. Observe the processing guidelines for creating the FLK!



DOYMA products are continuously being further developed. Technical changes will be made without prior notice.
More information at www.doyma.com

DOYMA GmbH & Co

SEALING SYSTEMS

FIRE PROTECTION SYSTEMS

Industriestr. 43-57
28876 Oyten

Phone: 0 42 07/91 66-0
Fax: 0 42 07/91 66-199

www.doyma.de
info@doyma.de

